

24 LOCK MANUAL HORIZONTAL REVOLVING

This type of wrist, normally locked, allows for releasing the perpendicular axis to the tool body, through the relevant manual command located at the back of the wrist, making possible a 360° rotation with a 15° connection level.

Note: When the tightening axis is parallel to the rotation of the wrist, an electric induction safety sensor prevents the tool from being activated if there is no connection.

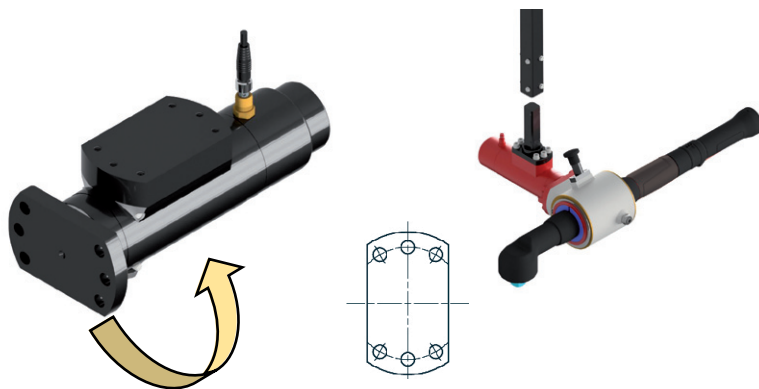

6 HOLES

WRIST MODEL	TORQUE LIMIT	SENSORE INDUTTIVO	AVAILABLE ACCESSORY FOR EACH ARM	NUMBER OF FLANGE HOLES	VERTICAL ROD	WEIGHT
	Nm					
PLO310000	150	NO	1	6	30X30	5
PLO311000	150	SI	1	6	30X30	5
PLO411000	500	NO	2-3	6	40X40	5
PLO411000	500	SI	2-3	6	40X40	5
PLO511000	1000	NO	3-5	6	50X50	8,5
PLO511000	1000	SI	3-5	6	50X50	8,5

REVOLVING TOOL BODY AXIS

Questo tipo di polso viene impiegato esclusivamente per utensili a angolo per creare una spaziatura lungo l'asse del corpo dell'utensile che consente rotazioni all'angolo richiesto, da notificare al momento dell'acquisto.

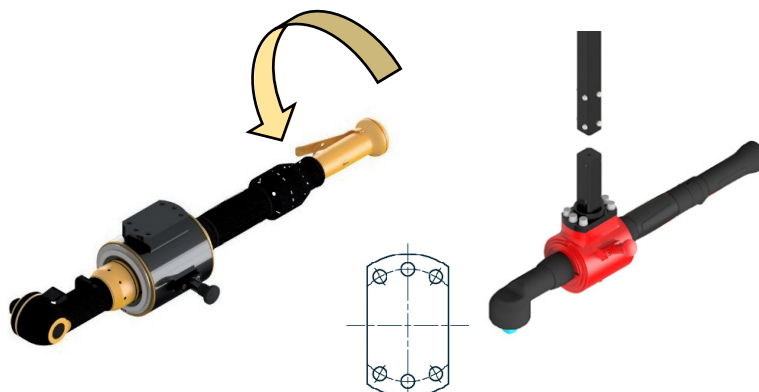

6 HOLES

WRIST MODEL	TORQUE LIMIT	AVAILABLE ACCESSORY FOR EACH ARM	NUMBER OF FLANGE HOLES	VERTICAL ROD	WEIGHT
	Nm				
PAO310000	150	1	6	30X30	*
PAO410000	500	2-3	6	40X40	*
PAO510000	1000	3-5	6	50X50	*
PAO610000	2000	5	6	60X60	*

* The WEIGHT varies depending on the size of the toolutilizzare.